





Students NEW to Blundel
 Meet at the main entrance to the school
 where Mr. Cooper's by the red check
 mark.

EMERGENCY PREPAREDNESS LEGEND

-  ANNUNCIATOR
-  FIRE ALARM PANEL
-  MAIN WATER SHUT-OFF
-  GAS METER/ SHUT-OFF
-  ELECTRICITY MAIN DISCONNECTION

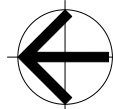
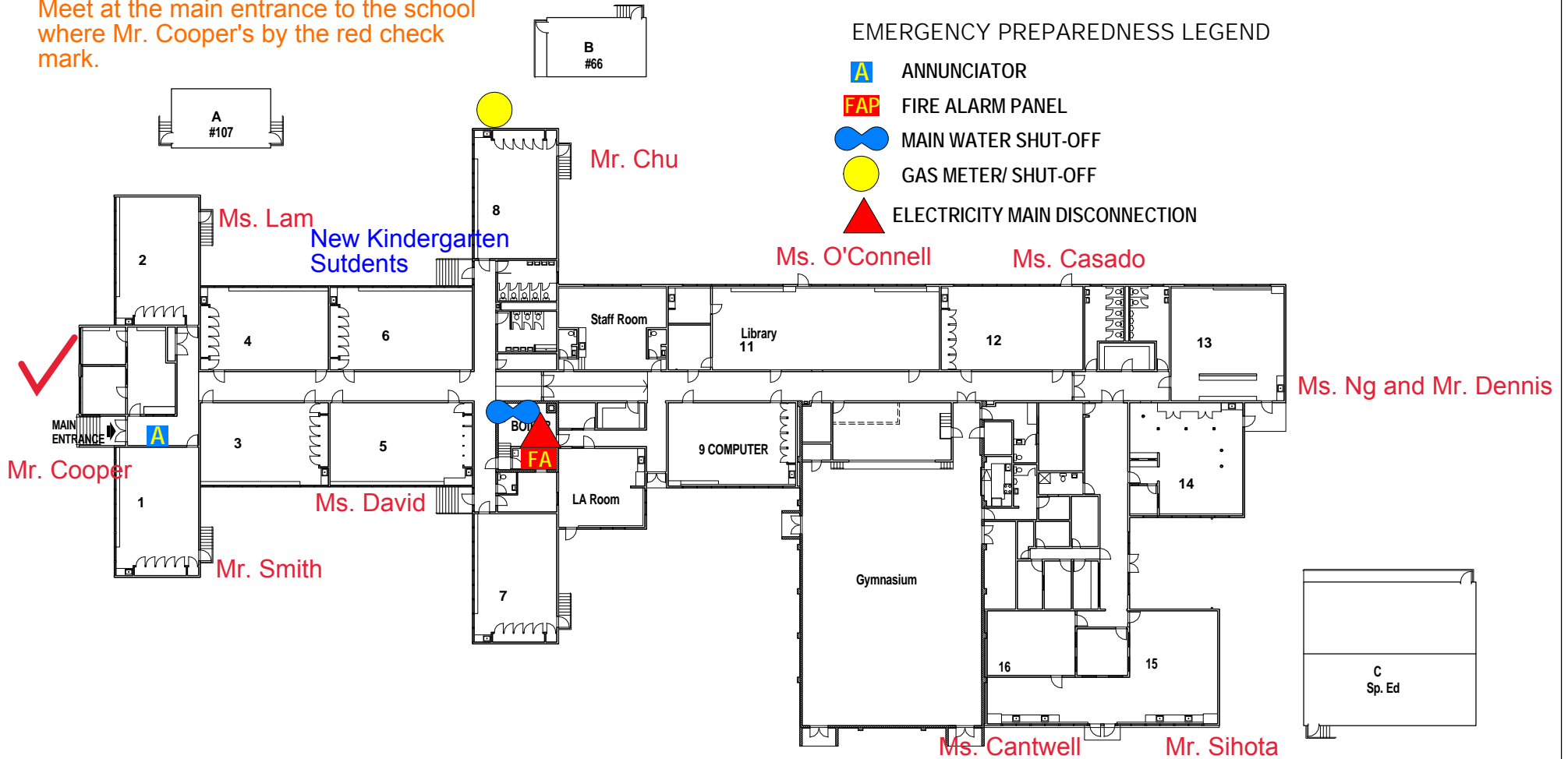

EMERGENCY PREPAREDNESS MAP

BLUNDELL ELEMENTARY SCHOOL

6480 BLUNDELL ROAD RICHMOND BC V7C 1H8

ID #:
210

DATE:
10/23/18